

ACTUATOR LA35

Features:

- 12 / 24V DC permanent magnet motor
- Thrust up to 6000 N in push and up to 4000 N in pull
- Heavy duty aluminum housing for harsh conditions
- Elegant and compact design with small installation dimensions
- Protection class: IP66 for outdoor use (dynamic), furthermore the actuator can be washed down by a high pressure cleaner (IP69K – static)
- Integrated brake, high self-lock ability
- Built-in limit switches
- Strong wear and corrosion resistant stainless steel inner tube
- Noise level 48dB(A); measuring method DS/EN ISO 3746, actuator not loaded

Options:

- Hall effect sensor
- Potential free signal switches for detecting inner and outer position
- Long life absolute feedback
- Easy to use interface – with integrated power electronics for direct PLC connection
- Large variety of back fixtures and piston rod eyes
- Exchangeable cables in different lengths
- Safety nut in push

Usage:

- Duty cycle: Max 10% or 2 minutes continuous use followed by 18 minutes not in use, at an ambient temperature of 25° C
- Ambient temperature -25°C to +60°C

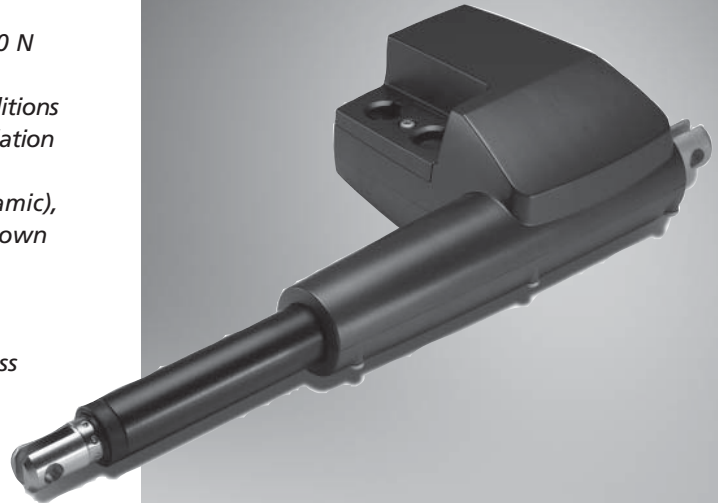

TECHLINE™
IMPROVING FLEXIBILITY

The LA35 is a member of the TECHLINE™ Family it is characterised by its robust design allowing the actuator to be used in harsh conditions. The LA35 is designed to meet the challenge, based on the philosophy that it must be able to operate under extreme conditions. The actuator is ideal for mobile "off-highway" equipment such as agricultural, forestry and construction machines. Furthermore the LA35 actuator is a very quiet and powerful actuator designed for a variety of applications both indoor and outdoor.

LA35 with 12V motor

Order number	Push max. (N)	Pull max. (N)	Self-lock min. (N) Push	Self-lock min. (N) Pull	Pitch (mm/spindle rev.)	Typical speed (mm/s)		Standard stroke lengths (mm) in steps of 50mm	Typical amp.	
						No load	Full load		No load	Full load
3510xx.	6000	4000	6000	4000	3	4.7	3.3	100-300	1.6	7.5
3520xx.	4000	4000	1500	1500	5	7.7	5.3	100-400	1.7	7.7
3521xx. push brake	4000	4000	2500	1500	5	7.2	5.4	100-400	3.2	7.8
3522xx. pull brake	4000	4000	1500	2500	5	6.9	5.9	100-400	4.2	8.4
3530xx.	1500	1500	750	750	9	14.0	12.3	100-500	1.7	5.9
3531xx. push brake	1500	1500	1000	750	9	14.2	12.6	100-500	2.9	5.5
3532xx. pull brake	1500	1500	750	1000	9	14.4	11.2	100-500	3.0	5.4
3540xx.	1000	1000	750	750	12	19.0	17.0	100-600	1.9	5.3
3541xx. push brake	1000	1000	1000	750	12	17.9	16.9	100-600	5.5	5.5
3542xx. pull brake	1000	1000	750	900	12	16.9	15.4	100-600	5.6	5.6

LA35 with 24V motor

Order number	Push max. (N)	Pull max. (N)	Self-lock min. (N) Push	Self-lock min. (N) Pull	Pitch (mm/spindle rev.)	Typical speed (mm/s)		Standard stroke lengths (mm) in steps of 50mm	Typical amp.	
						No load	Full load		No load	Full load
3510xx.	6000	4000	6000	4000	3	5.1	4.0	100-300	0.9	4.2
3520xx.	4000	4000	1500	1500	5	8.3	6.6	100-400	0.8	4.8
3521xx. push brake	4000	4000	2500	1500	5	8.0	6.7	100-400	1.4	4.3
3522xx. pull brake	4000	4000	1500	2500	5	8.0	7.0	100-400	2.1	4.6
3530xx.	1500	1500	750	750	9	15.0	13.9	100-500	0.6	2.6
3531xx. push brake	1500	1500	1000	750	9	14.5	14.1	100-500	1.2	2.9
3532xx. pull brake	1500	1500	750	1000	9	14.7	13.9	100-500	1.5	3.0
3540xx.	1000	1000	750	750	12	19.5	18.9	100-600	0.9	2.8
3541xx. push brake	1000	1000	1000	750	12	18.5	18.7	100-600	1.3	2.8
3542xx. pull brake	1000	1000	750	900	12	18.4	18.6	100-600	1.5	2.9

Stroke length v's load:

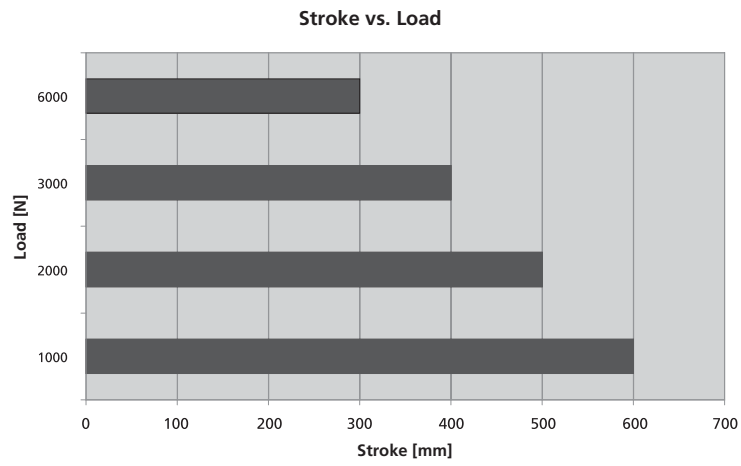

Dimensions:

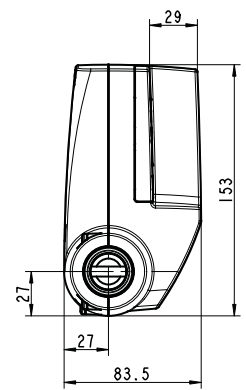
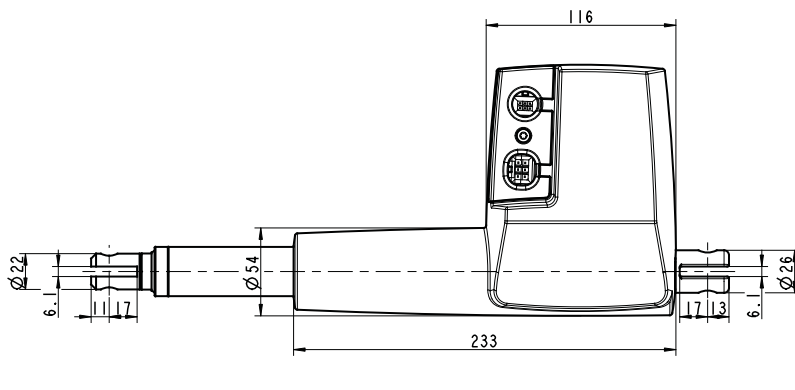
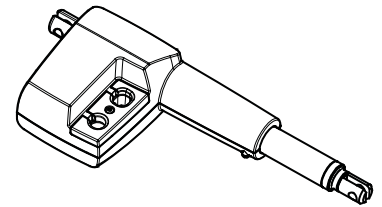
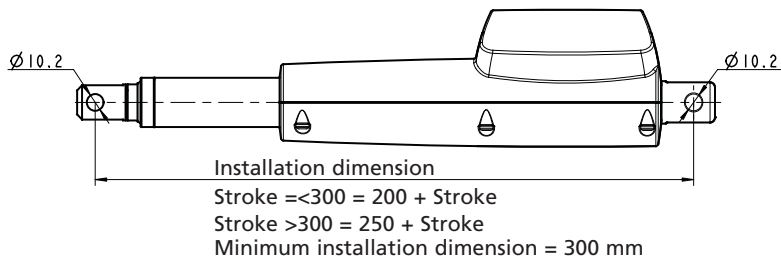

Drawing no.: 0359012

Back fixtures:



Type 1, 3, A



Type 2, 4, B

LA35

Ordering example:

35 1 0 1 0 + 0 0 x x x A 2 1

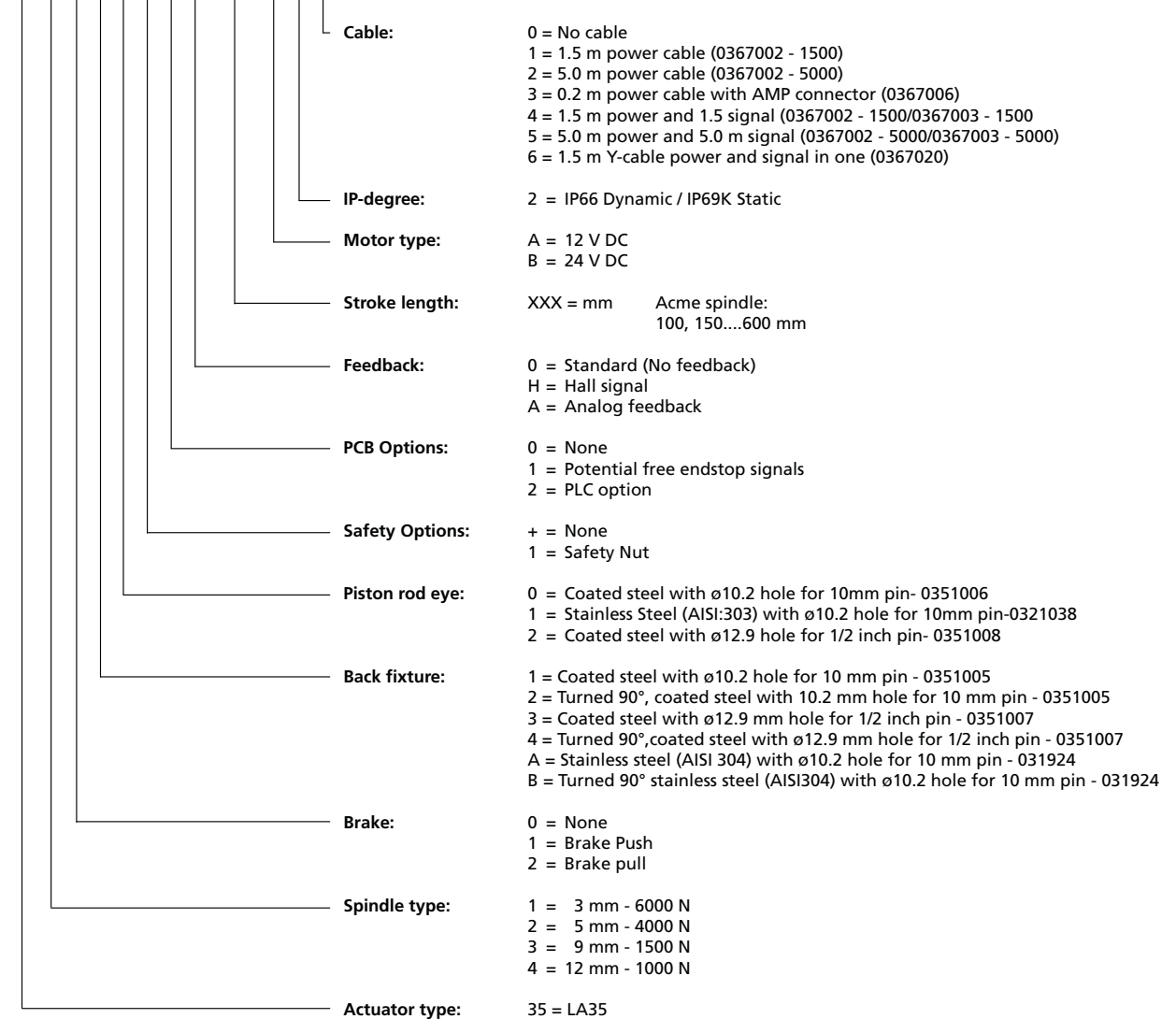

Connection diagrams:

Basic actuator

Fig.1 : 35xxxxx00xxxxx

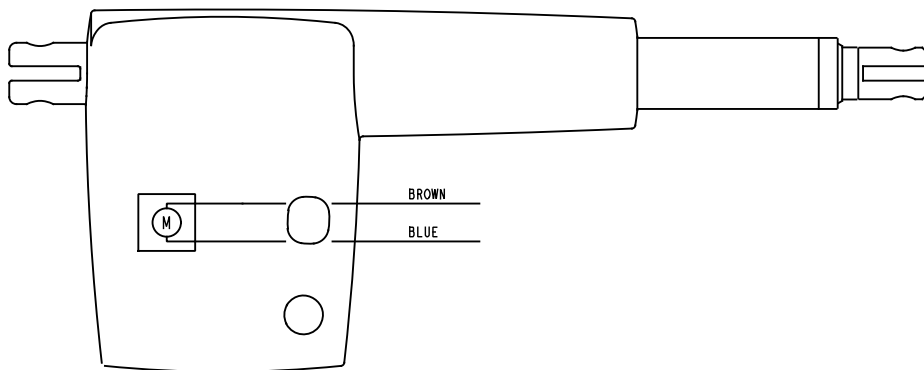

Actuator with potential free switches

Fig.2 : 35xxxxx10xxxxx

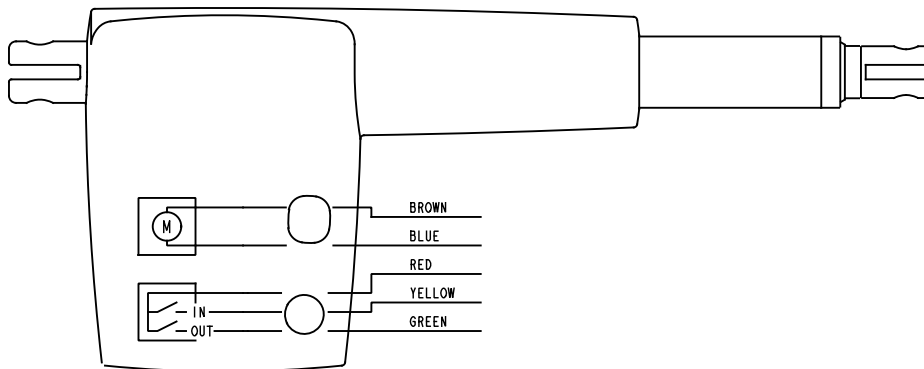

Actuator with potential free switches and relative positioning

Fig.3 : 35xxxxx0Hxxxxx & 35xxxxx1Hxxxxx

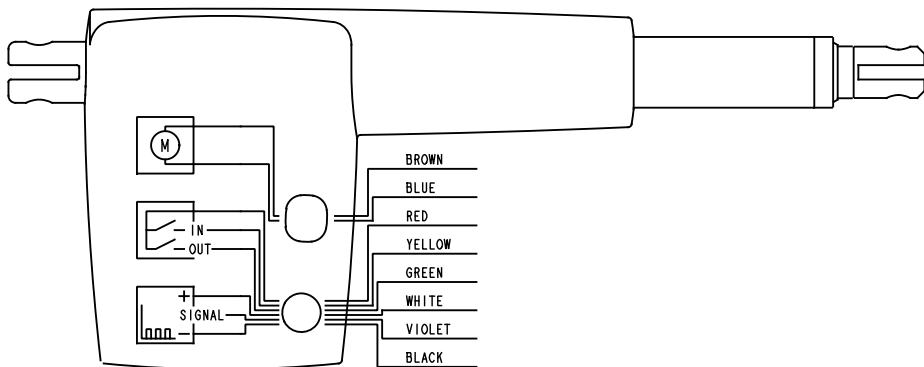

Actuator with potential free switches and absolute positioning

Fig.4 : 35xxxxx0Axxxxx & 35xxxxx1Axxxxx

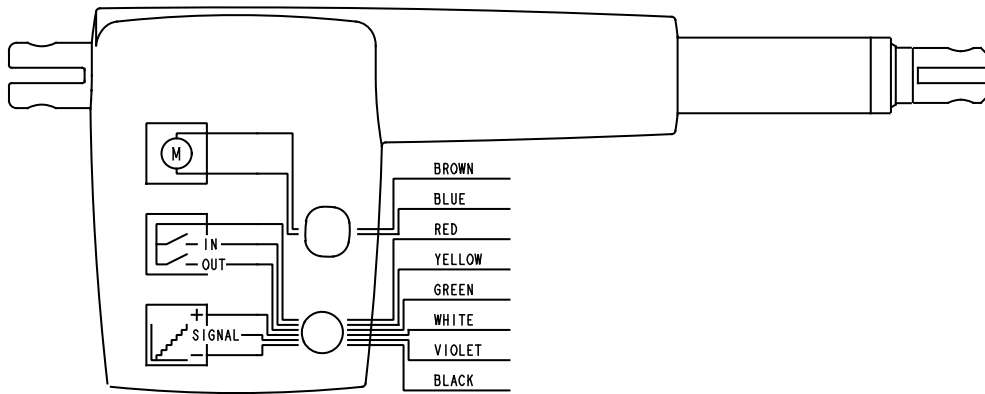

Actuator with PLC-option

Fig.5 : 35xxxxx20xxxxx & 35xxxxx2Hxxxxx & 35xxxxx2Axxxxx

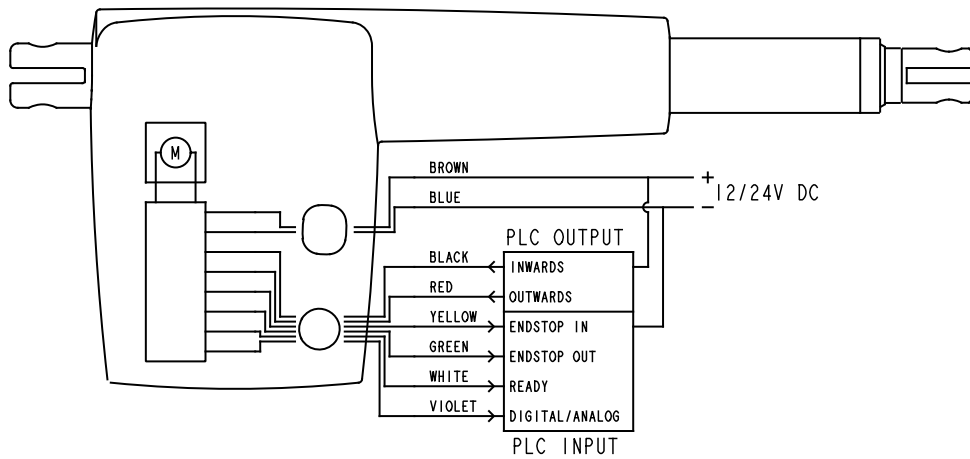

Speed and current curves:

LA35 12V Motor current v's load

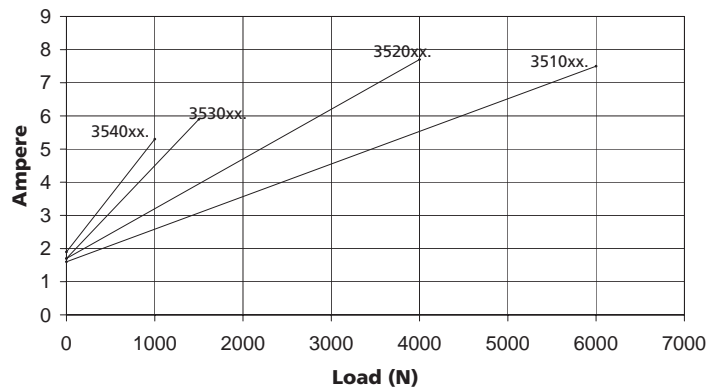

LA35 12V Motor speed v's load

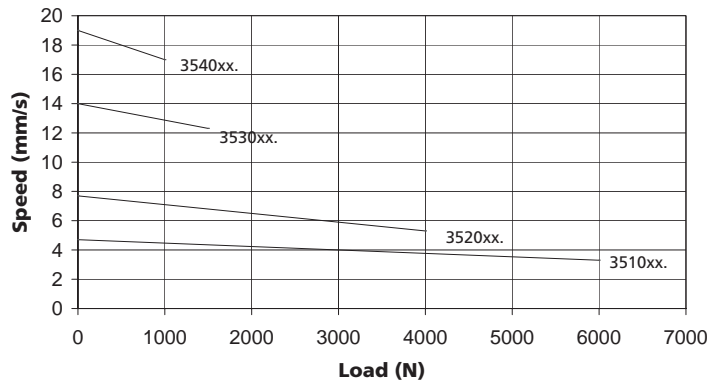

LA35 24V Motor current v's load

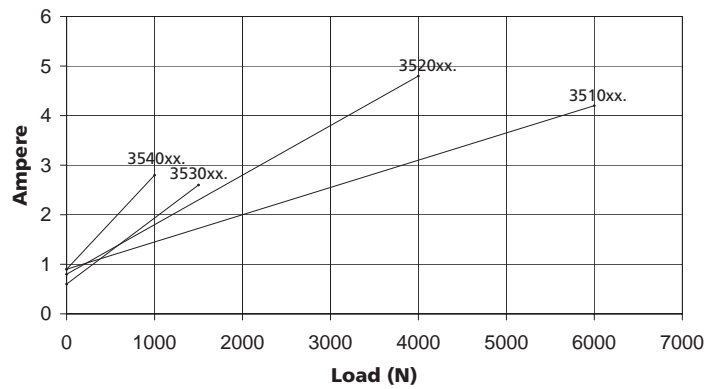

LA35 24V Motor speed v's load

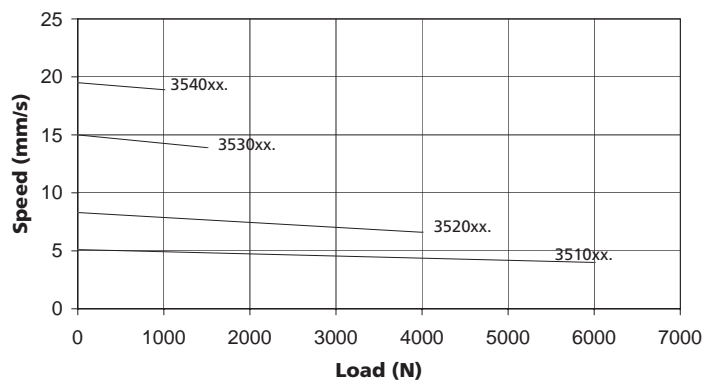

Terms of use

The user is responsible for determining the suitability of LINAK products for specific application. LINAK takes great care in providing accurate and up-to-date information on its products. However, due to continuous development in order to improve its products, LINAK products are subject to frequent modifications and changes without prior notice. Therefore, LINAK cannot guarantee the correct and actual status of said information on its products.

While LINAK uses its best efforts to fulfil orders, LINAK cannot, for the same reasons as mentioned above, guarantee the availability of any particular product. Therefore, LINAK reserves the right to discontinue the sale of any product displayed on its website or listed in its catalogues or other written material drawn up by LINAK.

All sales are subject to the Standard Terms of Sale and Delivery for LINAK. For a copy hereof, please contact LINAK.